



Signaletic,
it plays a key role in navigating
the Rasude. More than just
signs, it's a system designed
to support the building's public
function by guiding movement
and clarifying circulation.

This booklet explores the
graphic language designed for
this purpose.

The Colours



We've chosen bright, fun colours that stand out from the grey monotony of concrete. They are eye-catching and inviting. There are six colours, one for each Rasude path connecting the 4 four entrances.

The Arrow

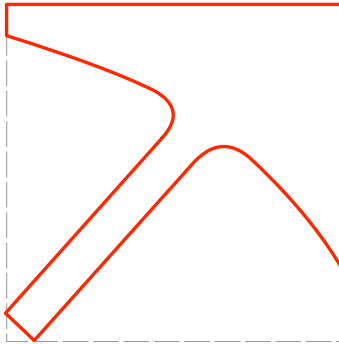
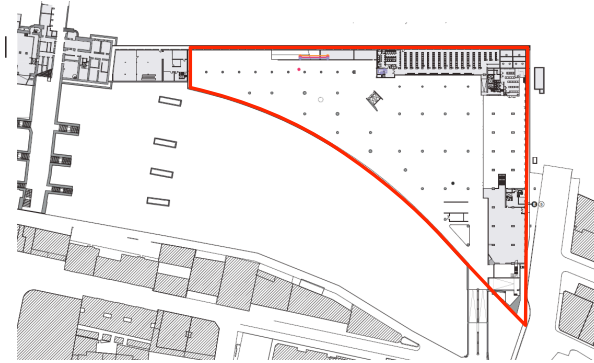

The arrow is the plan of the Rasude retraced

The Signs



La Poste



Simplon

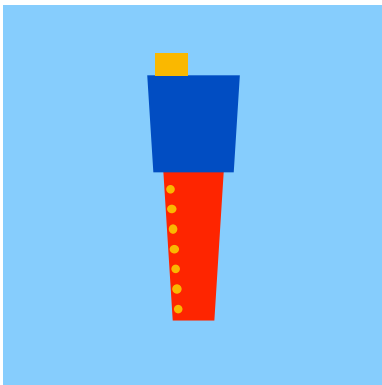

Ouchy

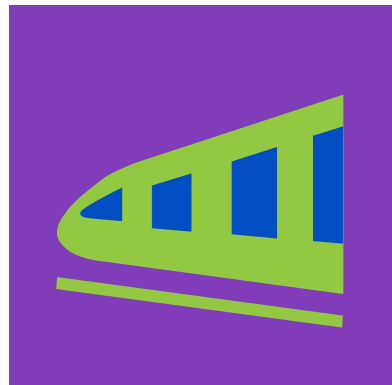

La Gare

La Rasude has 4 main entrances, to differentiate them and to help understand the internal circulation, they each need their own logo. They use the six colours of the paths.

The Font

POSTE

SIMPLON

BAR

OUCHY

GARE

The font follows a grid similar to that of the columns. The lines meander like subway lines

The Rasude

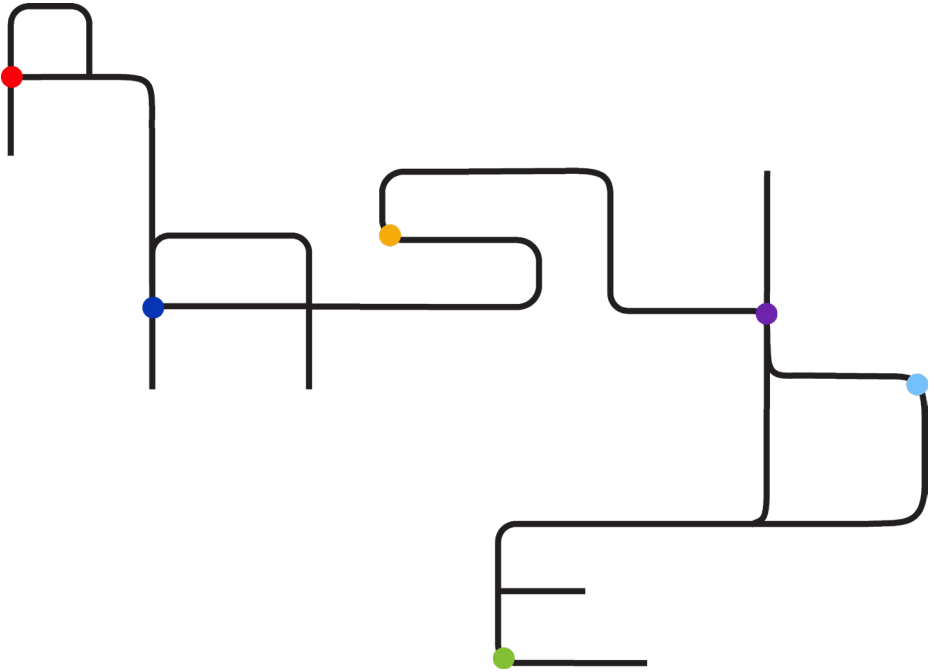

Variation of the font for signs

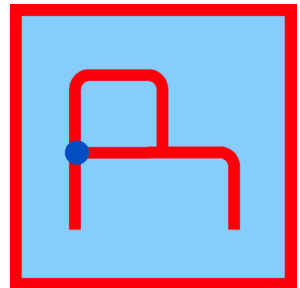
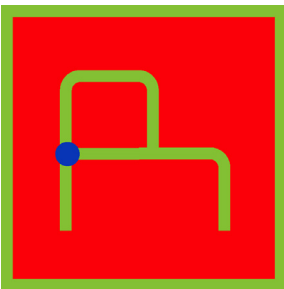
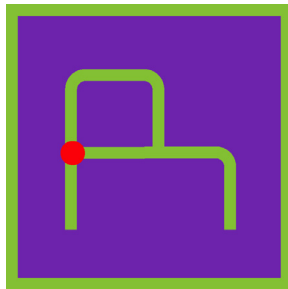
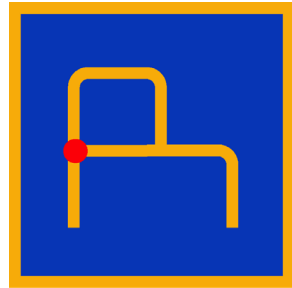
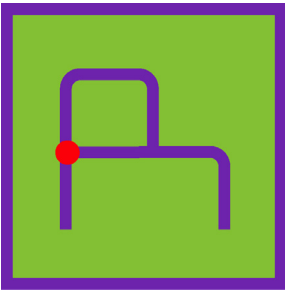
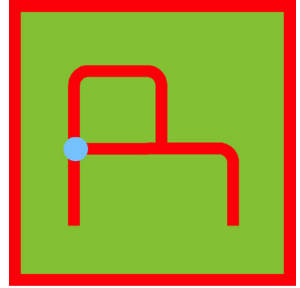
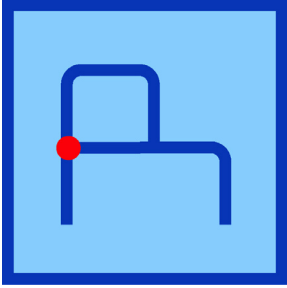

The Paths

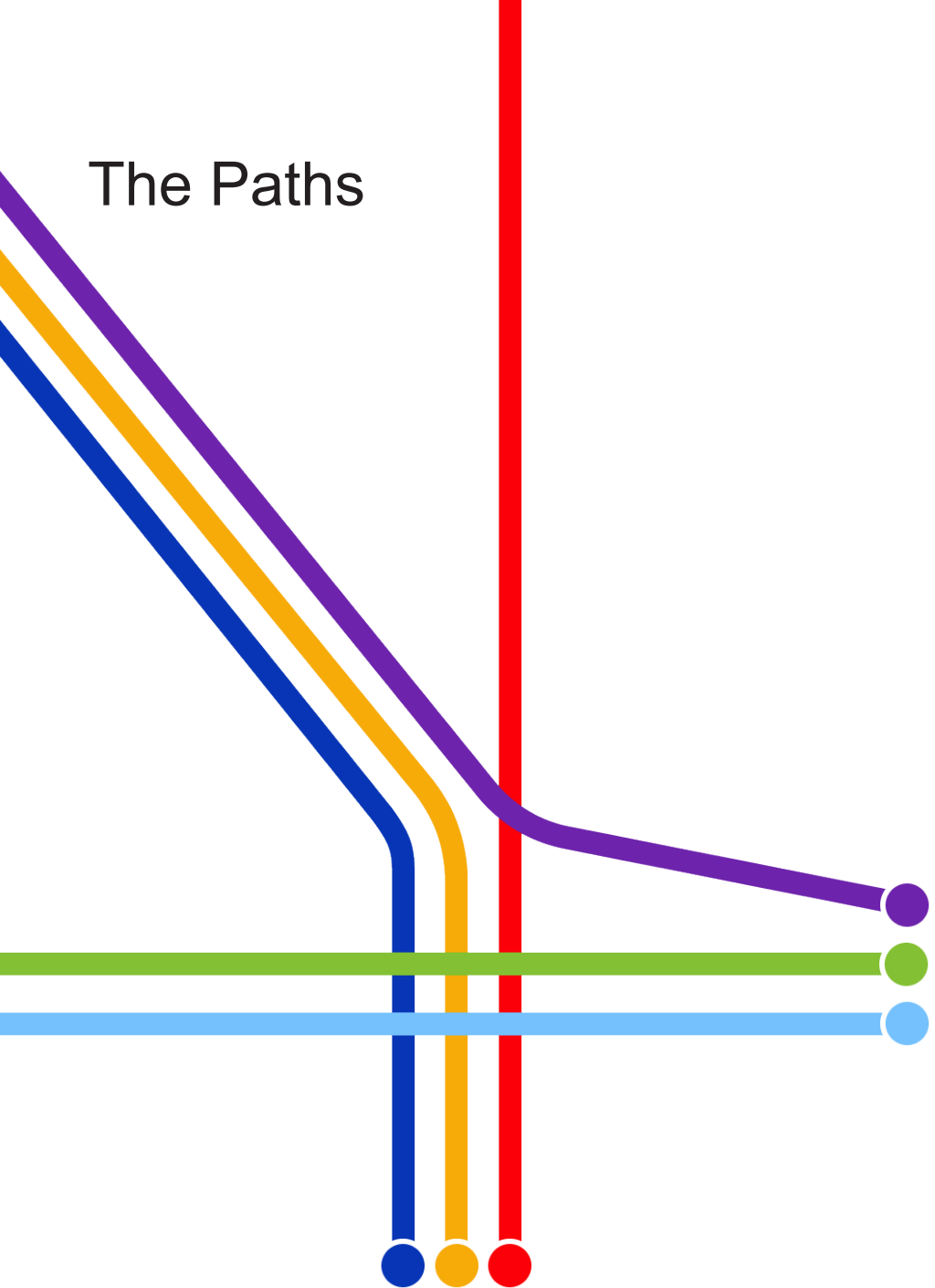

The six paths are painted on the ground to resemble subway lines.

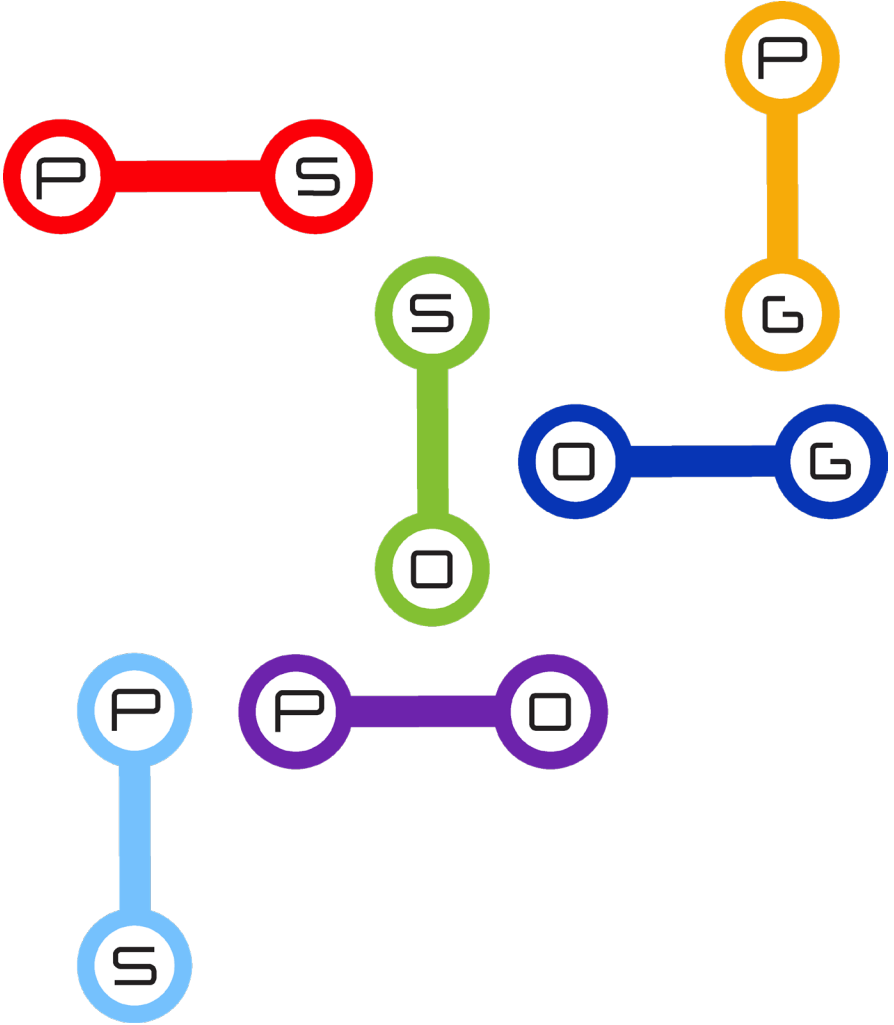

The Morris Column

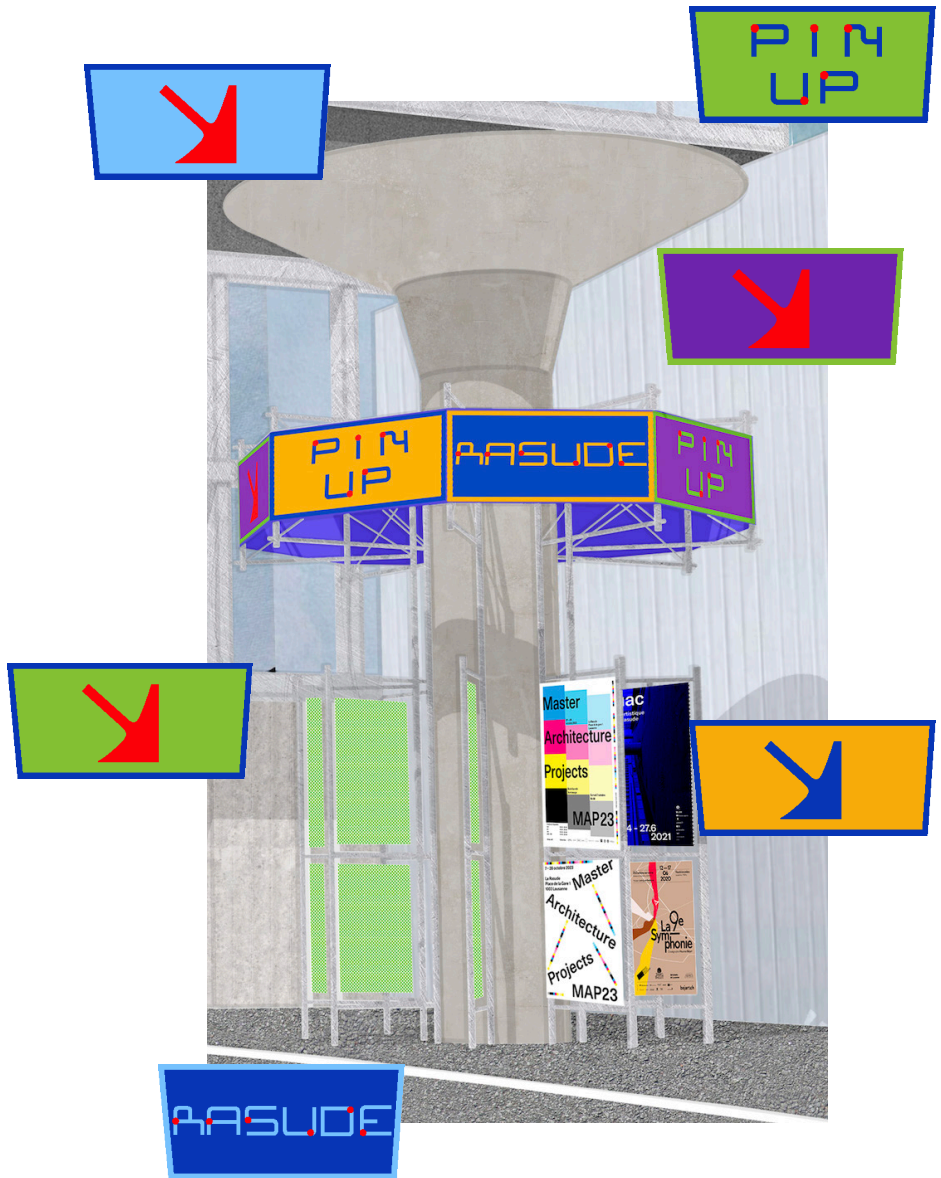

The Poster

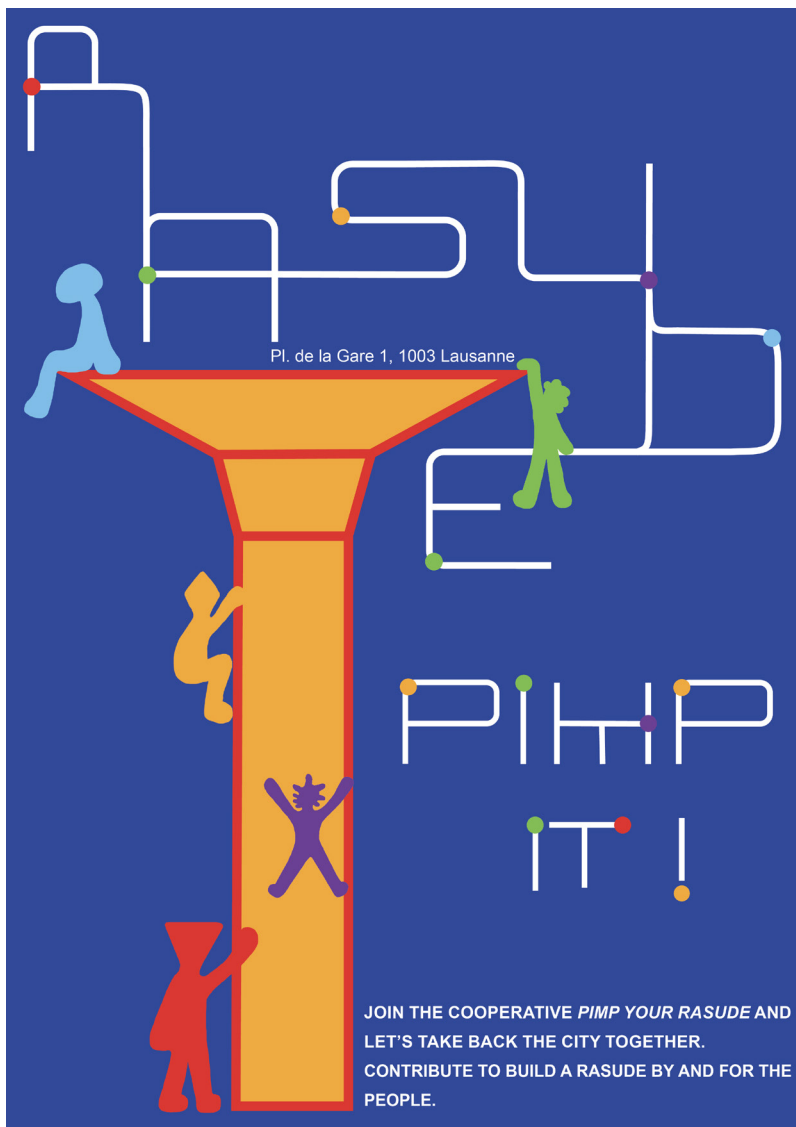

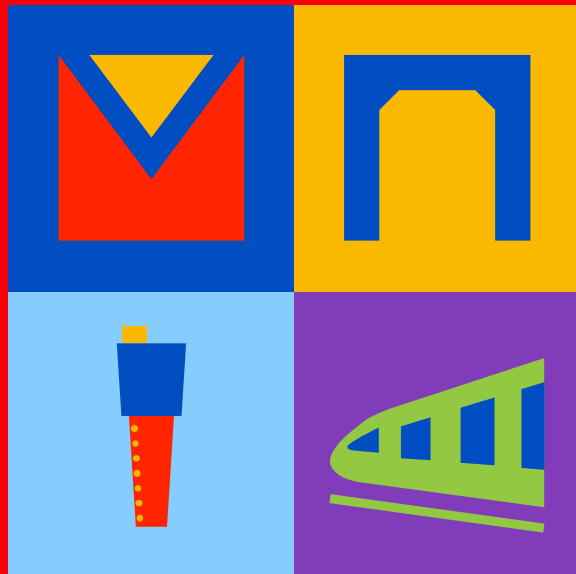

Friedli Eddy, Lepori Michelle, Lorenzo Esteban, Mizrahi Costanza
Signaletic, Pimp my Rasude
Spring 2025, RIOT, EPFL