

All work is made possible thanks to the workers mentioned below

- Masons
- Crane driver
- Scaffolders
- Carpenter
- Hemp concrete
- Spreaders
- Joiner
- Electricians
- Plumbers
- Heating Installers
- Parquet Installers
- Tilers
- Plasterers
- Painters
- Cleaners
- Architects
- Engineers
- Project Owner

TYPE		Plan as built	
PHASE	52 Archives	DATE	10.07.25
LEVEL	0+1	SCALE	1/100
LOCALISATION	Chemin du Viaduc 12, plot 994-875, 1008 Prilly, Vaud, CH	TOLERANCE	15 cm
COALITION		Drill on Design - Amending SIA 102 - Toward a Labour Centered Architecture	

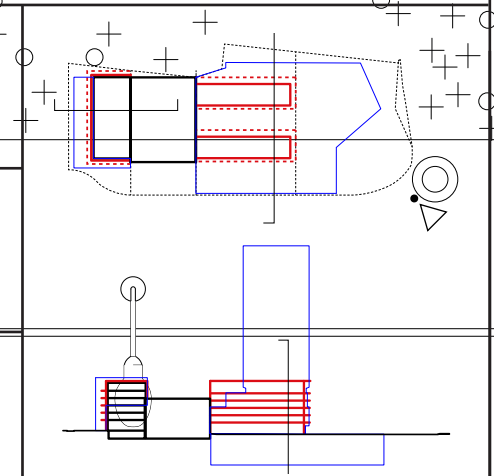

& future workers



excavation  
50000 m<sup>3</sup>  
earth transported to landfill sites

excavation  
2500 m<sup>3</sup>  
excavated earth used on site for landscaping

crane  
on concrete slab  
need of carbon reinforced pillars  
3 cranes on site for construction speed

crane  
on natural ground  
1 crane needed on site

pipes  
15 piping system per 11 people

pipes  
2 piping systems per 11 people

All work is made possible thanks to the workers mentioned below

- Masons
- Crane driver
- Scaffolders
- Carpenter
- Hemp concrete
- Spreaders
- Joiner
- Electricians
- Plumbers
- Heating Installers
- Parquet Installers
- Tilers
- Plasterers
- Painters
- Cleaners
- Architects
- Engineers
- Project Owner

TYPE		Plan as built	
PHASE	5.2 Archives	DATE	10.07.25
LEVEL	0+1	SCALE	1/100
LOCALISATION	Chemin du Viaduc 12, plot 994-875, 1008 Prilly, Vaud, CH	TOLERANCE	15 cm
COALITION Drill on Design - Amending SIA 102 - Toward a Labour Centered Architecture			

& future workers